

Plat of Survey

of

Lot 2 of Certified Survey Map No. 721,

recorded in Vol. 3 of Certified Survey Maps of Walworth County on Page 228 and located in the Southeast 1/4 of the Southwest 1/4 of Section 31, Town 2 North, Range 16 East, Town of Delavan, Walworth County, Wisconsin.

Surveyed for: **Dan McCabe**
2568 County Road O South
Delavan, Wisconsin. 53115

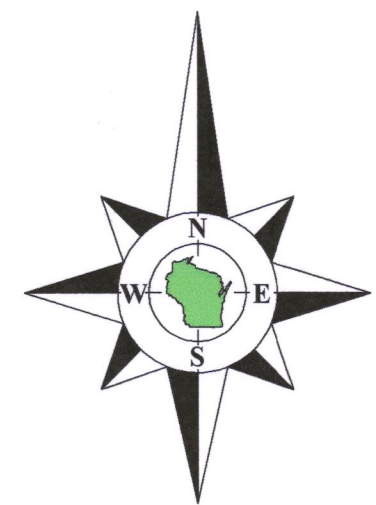

Bearings referenced to the East line of Certified Survey Map No. 721, recorded as N0°27'20"E, which produces a bearing of N0°19'05"E on the East line of the Southwest 1/4 of Section 31-2-16. A rotation of 2°00'15" from the Wisconsin State Plane Coordinate System, South Zone, (NAD-27).

Coordinates are referenced to the Wisconsin State Plane Coordinate System, South Zone, (NAD-27).

Channel Drive

(35' Wide)

Lot 183

Lot 184

Lot 185

Lot 186

Lot 187

L a k e

D e l a v a n

Lot 177

Lot 178

Lot 179

Lot 180

Lot 181

Lot 182

Center 1/4 Corner
Section 31-2-16
(N. 217,784.00)
(E. 2,363,851.27)

Lot 1
C.S.M. 721

recorded as(N89°46'20"E 180.99')
N89°45'18"E 181.24'

Well

House
No. 2568

Lot 2
Tax Parcel
FA 72100002
1.454 Acres
63,352 Sq.Ft.

Shed

Outlot 1
C.S.M. 721

Formerly Ridge Avenue
Discontinued by the Town of Delavan
Vol. 181, Page 233
Doc. No. 252084
Dated 08-20-1985.

recorded as(65.99')
66.09'
S89°59'48"W
recorded as(S89°46'20"W)

N0°19'05"E 439.10'
29.31'

South 1/4 Corner
Section 31-2-16
(N. 215,138.14)
(E. 2,363,929.16)

recorded as(N12°13'40"W 523.73')
N12°14'44"W 523.66'

No Access as shown on CSM 721

Culvert

County Trunk Highway O
(100' Wide)

Legend of Symbols & Abbreviations

Found County Section Corner
Found Iron Pipe
Found Iron Rod
Set Iron Pipe, 1" dia.
Recorded Information
Utility Pole
Asphalt Surface
Gravel Surface
Concrete
Brick Pavers
N North
S South
E East
W West
In Bearings
Degrees
Minutes
Seconds
In Distances
Feet
Inches

OLSON
LAND SURVEYING, LLC
Rural | Residential | Commercial

45 South Wisconsin Street | P.O. Box 322
Elkhorn, Wisconsin. 53121
Telephone: (262) 723-3434
Facsimile: (262) 723-8044
Email: doug@olsonsurveying.com
Website: www.olsonsurveying.com

Scale in Feet
1" = 30'

0' 15' 30' 60' 90'

Survey Date: March 23, 2017.
Revisions:

Douglas G. Olson
Wisconsin Professional Land Surveyor - 2093

Notes:

- This Plat of Survey is not certified unless signed and sealed in red ink.
- This survey is subject to Wisconsin lien laws. This Plat of Survey is the notice of intent to file lien. Lien waiver required.
- The Survey Date shown on this Plat of Survey is the completion date of the field work.

Copyright© 2017 by Olson Land Surveying, LLC.

All rights reserved. No part of this survey plat may be reproduced or transmitted in any form by any means - graphic, electronic, or mechanical, including photocopying, tracing, or information storage and retrieval systems - without permission in writing from Douglas G. Olson, Olson Land Surveying, LLC.

I hereby certify that I have surveyed the above described property in compliance with Chapter A-E 7 of the Wisconsin Administrative Code and that the map hereon is correct to the best of my knowledge and belief.

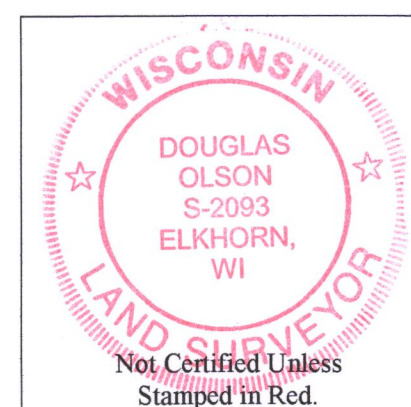

2017.018

Sheet 1 of 1 Sheets

Drawing Name:

Job Reference Number
2017.018